

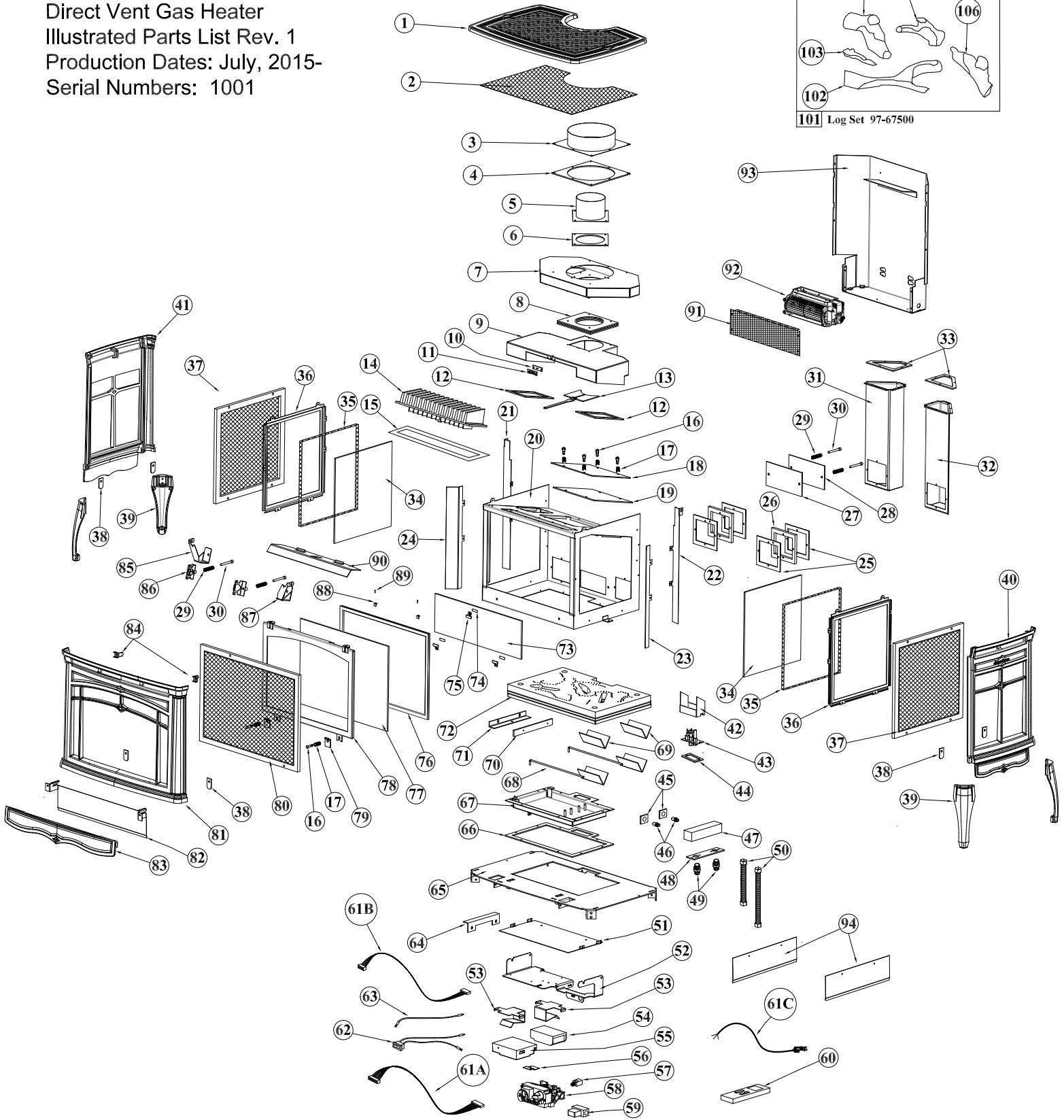

Waitsfield DX Model# 8770
Direct Vent Gas Heater
Illustrated Parts List Rev. 1
Production Dates: July, 2015-
Serial Numbers: 1001

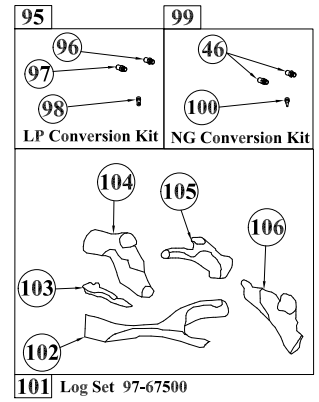



Model: Waitsfield Mdl.# 8770

Production: Jul-15

Serial #: 1001-

Note: Specify color for enameled cast iron parts.

Key	Part #	Description	QTY.
1	2710-742	TOP: MATTE, WAI	1
2	5770-045	SCREEN: TOP, WAI	1
3	5701-926	COLLAR: INLET,6-5/8", BRI / WAI	1
4	3160-225	GASKET: FLUE INLET, BRI / WAI	1
5	5701-927	COLLAR: EXHAUST,4", BRI / WAI	1
6	3160-228	GASKET: FLUE EXIT, BRI / WAI	1
7	5710-320	INLET COLLECTOR: BRI/WAI	1
8	3160-210	GASKET:EXHAUST COLLAR, BRI / WAI	4
9	5770-300	EXHAUST COLLECTOR: WAI	1
10	3160-222	GASKET: RESTRICTOR CLIP, BRI3, WAI	1
11	5710-395	CLIP: RESTRICTOR PACKING, BRI / WAI	1
12	3160-200	GASKET: EXHAUST MANIFOLD, BRI/BRI3/WAI	2
13	5710-311	RESTRICTOR PLATE: BRI / WAI	1
14	2710-487	HEAT EXCHANGER: TUC2/STO2/STO3/BRI/WAI	1
15	3160-150	GASKET:HEAT EX,4"x14.5	1
16	4100-0285	SCREW: SHOULDER,5/16"Dx3/4"L,SOCKET	4
17	5000-108	SPRING:.48"ODx .5", 17-7SST, SPC 56268	6
18	5710-105	PLATE:DELAYED IGNITION, 8"x8", BRI/WAI	1
19	3160-108	GASKET: DELAYED IGNITION RELIEF, BRI/WAI	1
20	5770-200	FIREBOX: WAI	1
21	5770-240	CORNER SHIELD, REAR, LEFT, WAI	1
22	5770-245	CORNER SHIELD, REAR, RIGHT, WAI	1
23	5770-235	CORNER SHIELD, FRONT, RIGHT, WAI	1
24	5770-230	CORNER SHIELD, FRONT, LEFT, WAI	1
25	3160-220	GASKET: INLET COLLAR PLATE, BRI / WAI	4
26	5710-325	PLATE: INLET COLLAR, BRI / WAI	2
27	3160-105	GASKET:DELAY IGNIT,TUC/BRI/STO/STO3/WAI	1
28	5710-100	PLATE:DELAYED IGNITION, TUC 2/BRI/STO 2	1
29	5240-150	SPRING: COMPRESSION,17-7 PH SS SPC-56234	4
30	4500-1400	SCREW: CAP,1/4-20x2-1/4",HEX,ZN,GR5	4
31	5710-335	CHANNEL: PRIMARY AIR, LEFT, BRI/WAI	1
32	5710-330	CHANNEL: PRIMARY AIR, RIGHT: BRI/WAI	1
33	3160-215	GASKET: AIR INLET PLENUM, BRI / WAI	2
34	3030-064	GLASS:11.25"x 12.5", BRI/WAI	2
35	3160-081	GASKET: TAPE,3/4"x1/8",AD (1250'/SPOO	8.5 FT
36	5770-250	FRAME: SIDE GLASS, WAI	2
37	5770-035	SCREEN: SAFETY, SIDE GLASS, WAI	2
38	5710-250	BRACKET: LOWER MOUNT, TUC 2/BRI/WAI	6
39	2710-700	FOOT: MATTE, BRI/BRI3/WAI	4
40	2710-727	SIDE: RIGHT, MATTE, WAI	1
41	2710-722	SIDE: LEFT, MATTE, WAI	1
42	5710-307	SHIELD: PILOT, BRI / WAI	1
43	7211-332	PILOT: NG ASS'Y, IPI, PSE (PSE-C7-542)	1
44	3160-152	GASKET: PILOT,1.75"x3"	1
45	3160-126	GASKET: ORIFICE, BRI/BRI3/WAI	2
46	7200-445	ORIFICE: HOOD, MALE THREADS, #45	2
47	7211-056	MANIFOLD: GAS, BRI /WAI	1

Key	Part #	Description	QTY.
48	3160-207	GASKET: ORIFICE BLOCK, BRI/WAI	1
49	7211-003	FITTING: STRT,1/4"NPTx3/8"CMP(NUT&FER	2
50	7211-018	TUBE:GAS,FLEX,3/8"x12",321/78/05(T6-1	2
51	5323-020	HEATSHIELD: BOTTOM, STO, CHA, BRI, WAI	1
52	5323-010	BRACKET: VALVE MOUNT, STO, CHA, BRI, WAI	1
53	5323-030	BRACKET: CNTRL BOARD, STO, CHA, BRI, WAI	2
54	7000-382	BOARD: FAN CONTROL, MAX, (G6R-BUMV2)	1
55	7000-381	BOARD: GV60 RCV, MAX, (G6R-R3AU)	1
56	5323-015	VALVE SUPP CLIP, STO 3/CHA 2/BRI 3/WAI	1
57	7000-027	INTERRUPTER: THRMCP, MAX (G60-ZUS32)	1
58	7211-308	VALVE:NG,MAX,TAPPED(GV60M1-B5C3GL-0032)	1
59	7211-356	SOLENOID VALVE:SPLIT FLOW,MAX(GV-S60B/5)	1
60	7000-360	REMOTE: MAX, GV60, US (G6R-H3TV4)	1
61A	7000-044	WIRE HARNESS:8 WIRE, MAX, 500MM (G6R-C5)	1
61B	7000-043	WIRE HARNESS:RCVR, MAX, 500MM (G6R-CB5) 5 WIRE	1
61C	7000-061	WIRE : POWER SUPPLY, MAX, WAI, BRI 3	1
62	7000-028	WIRE:INTERRUPT, SW, MAX (G60-ZSKSS/500)	1
63	7000-029	WIRE: INTERRUPT, TC, MAX (G60-ZKIRS/500)	1
64	5770-140	BRACKET: VALVE MOUNT OFFSET	1
65	5770-130	BASE: WAI, STEEL	1
66	3160-205	GASKET: BURNER TRAY, BRI/WAI	1
67	5770-125	BURNER PAN: WAI	1
68	5770-215	AIR SHUTTER ASSY: BRI3, WAI	2
69	3160-202	GASKET: AIR SHUTTER, WAI	2
70	3160-212	GASKET: AIR SHUTTER LOCK, WAI	1
71	5770-150	BRACKET: AIR SHUTTER LOCK, WAI	1
72	7211-617	BURNER: EMBER, FOIL,BRI, WAI	1
73	3030-066	GLASS: MIRROR, 17" X 5.625", BRI/WAI	1
74	3120-021	GASKET: GLASS CLIP, BLACK	3
75	5021-060	CLIP: GLASS,HER 1/TRI	6
76	3160-060	GSKT: TAPE,1/4BDx5/8FLX7/8OA TADPOLE180'	5.17 FT
77	3030-062	GLASS:17"x 12", BRI/WAI	1
78	5710-360	FRAME: FRONT GLASS, BRI/WAI	1
79	5710-390	CLIP:FRONT GLASS MOUNT,BLK OXIDE,BRI/WAI	2
80	5770-040	SCREEN: SAFETY, FRONT GLASS, WAI	1
81	2710-732	FRONT: MATTE, WAI	1
82	5770-100	BRACKET: ASH LIP, WAI	1
83	2710-712	DOOR: CONTROL, MATTE, WAI	1
84	5710-375	BRACKET: FRNT MOUNT,BLACK OXIDE,BRI/WAI	2
85	5770-310	BRACKET: SIDE MOUNTING, LEFT, WAI	1
86	5710-279	HANDLE: SPRING HOOK, TUC 2/BRI/WAI	2
87	5770-315	BRACKET: SIDE MOUNTING, RIGHT, WAI	1
88	5710-365	CLIP: FRONT GLASS,BLK OX, BRI/DVI 38/44	2
89	4400-0203	RIVET: BLIND,1/8x1/8" GRIP,SS SEALED	10
90	5710-309	BAFFLE: BRI/WAI	1
91	5710-347	SCREEN: BLOWER, BRI / WAI	1
92	7211-944	FAN: BLOWER,ASSY,LEFT,CLY/BRI #J2388224	1
93	5770-210	DEFLECTOR: CONVECT AIR, WAI	1
94	5770-110	MODESTY PANEL, SIDE, WAI	2
95	97-56701	FUEL CONVERSION KIT (LP): WAI DX (8770) - Contains:	1
97	7200-453	ORIFICE: BURNER HOOD,MALE THREADS,#53	1
96	7200-469	ORIFICE:HOOD,MALE THREADS,#57	1
98	7211-174	ORIFICE:VALVE,LP,#230,MAX (G30-ZEOR230)	1

Waitsfield 8770 (cont.)

p.3

Key	Part #	Description	QTY.
99	97-56700	FUEL CONVERSION KIT (NG): WAI DX (8770) - Contains:	1
100	7211-176	ORIFICE: VALVE, NG, ADJUSTABLE, MAXITROL	1
46	7200-445	ORIFICE: HOOD, MALE THREADS, #45	2
101	97-67500	LOG SET: BRI / WAI - Contains:	1
102	7211-615	LOG: FRONT LEFT	1
103	7211-613	LOG: LEFT TWIG	1
104	7211-611	LOG: REAR LEFT	1
105	7211-612	LOG: REAR RIGHT	1
106	7211-614	LOG: FRONT RIGHT	1